

Dashboard

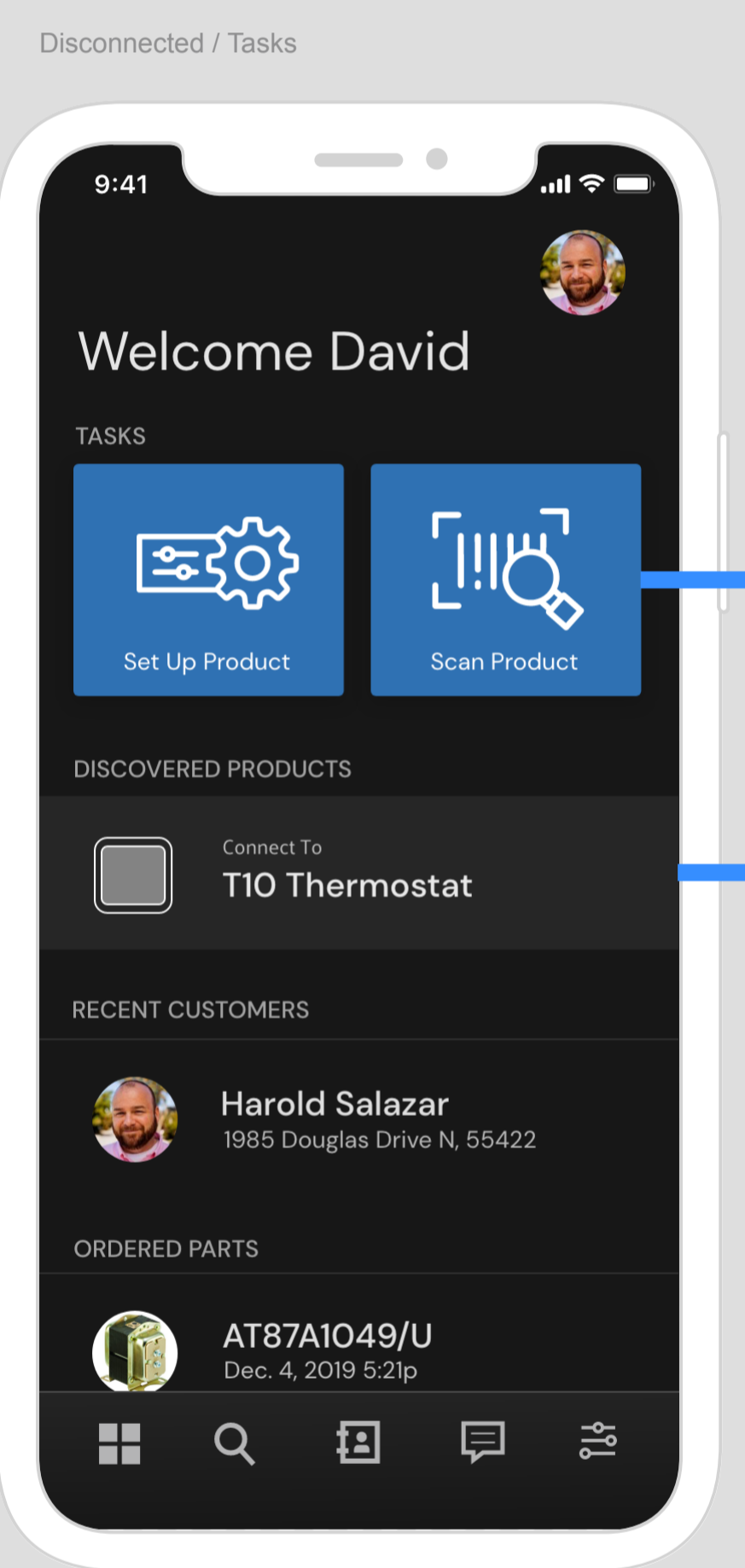

Set Up Product

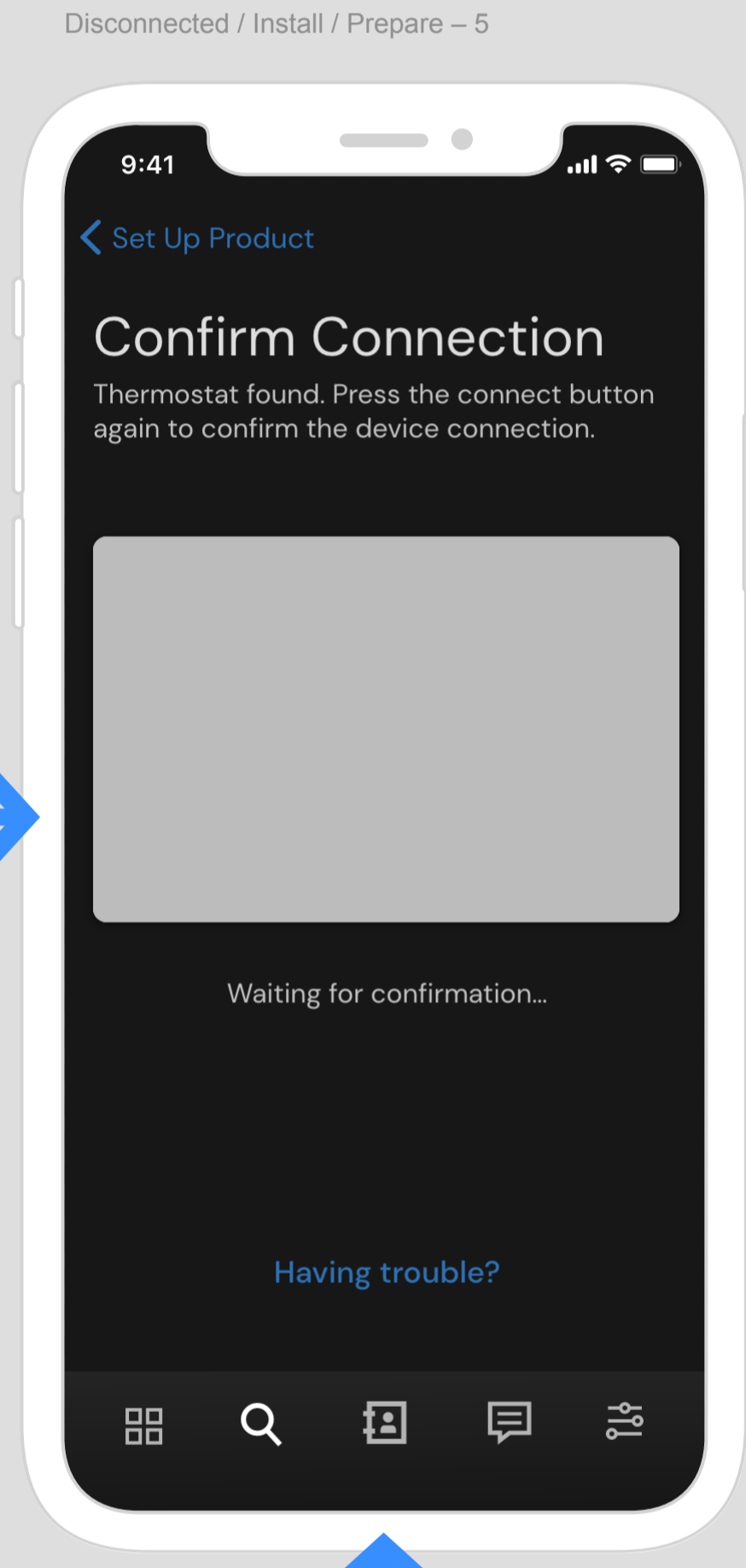
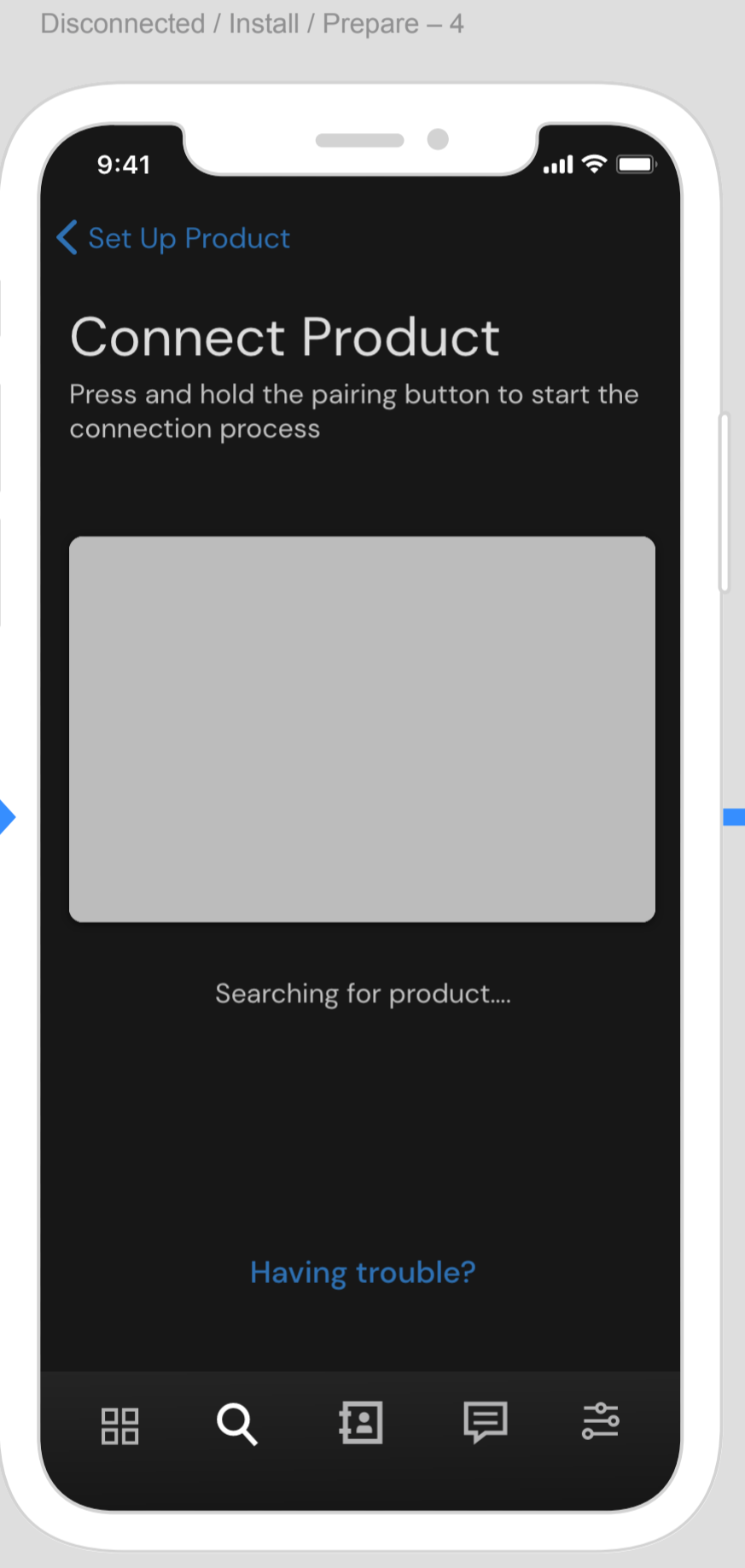
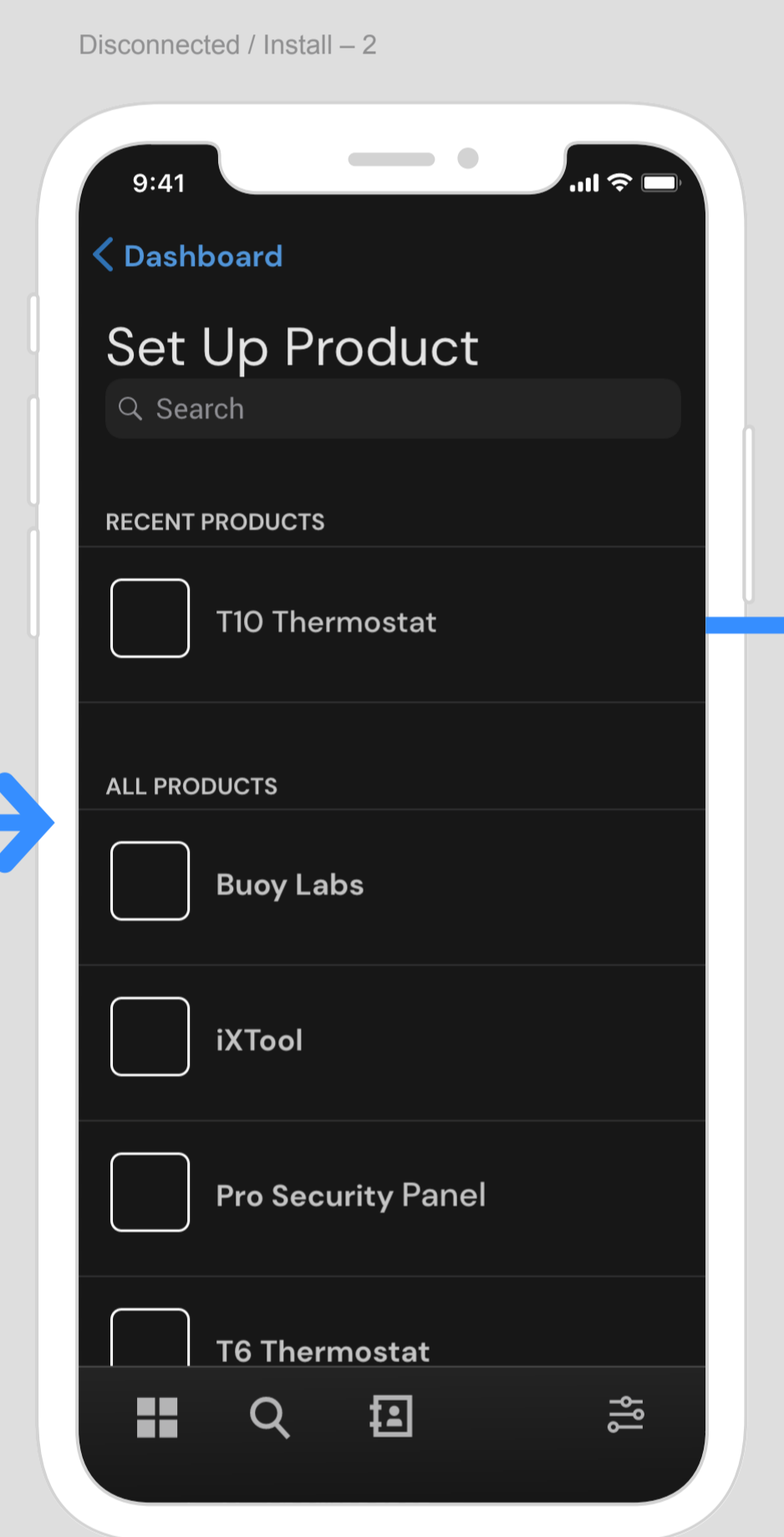

Configuration

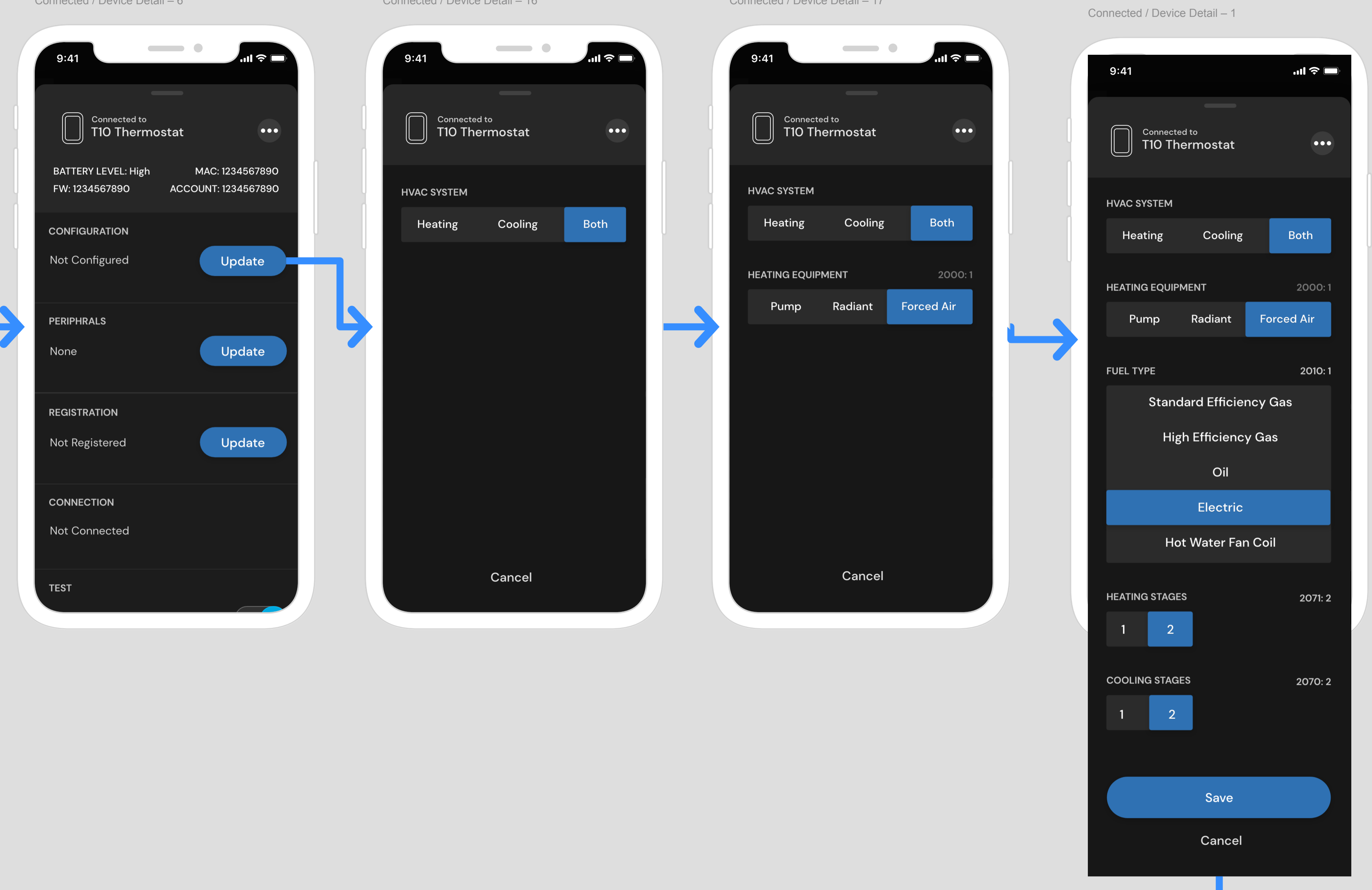

Peripherals

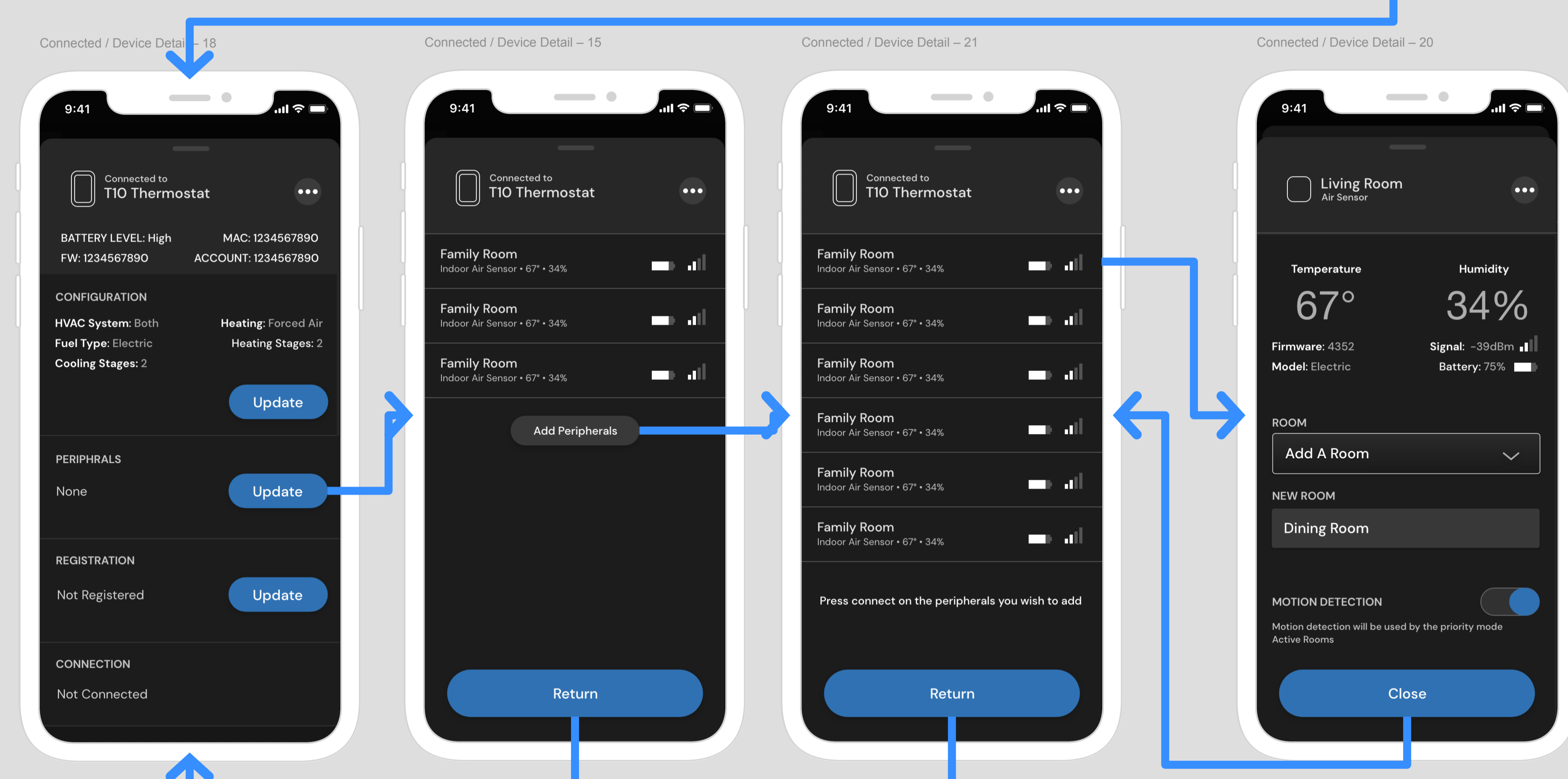

Registration

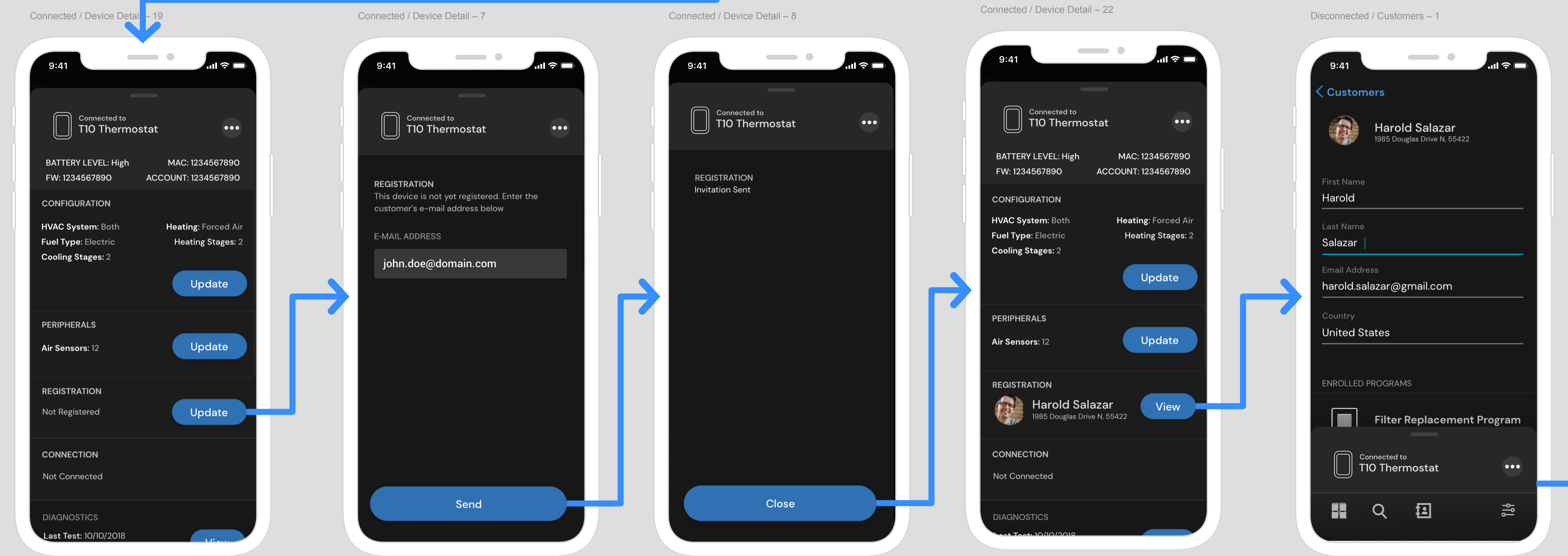

Diagnostics

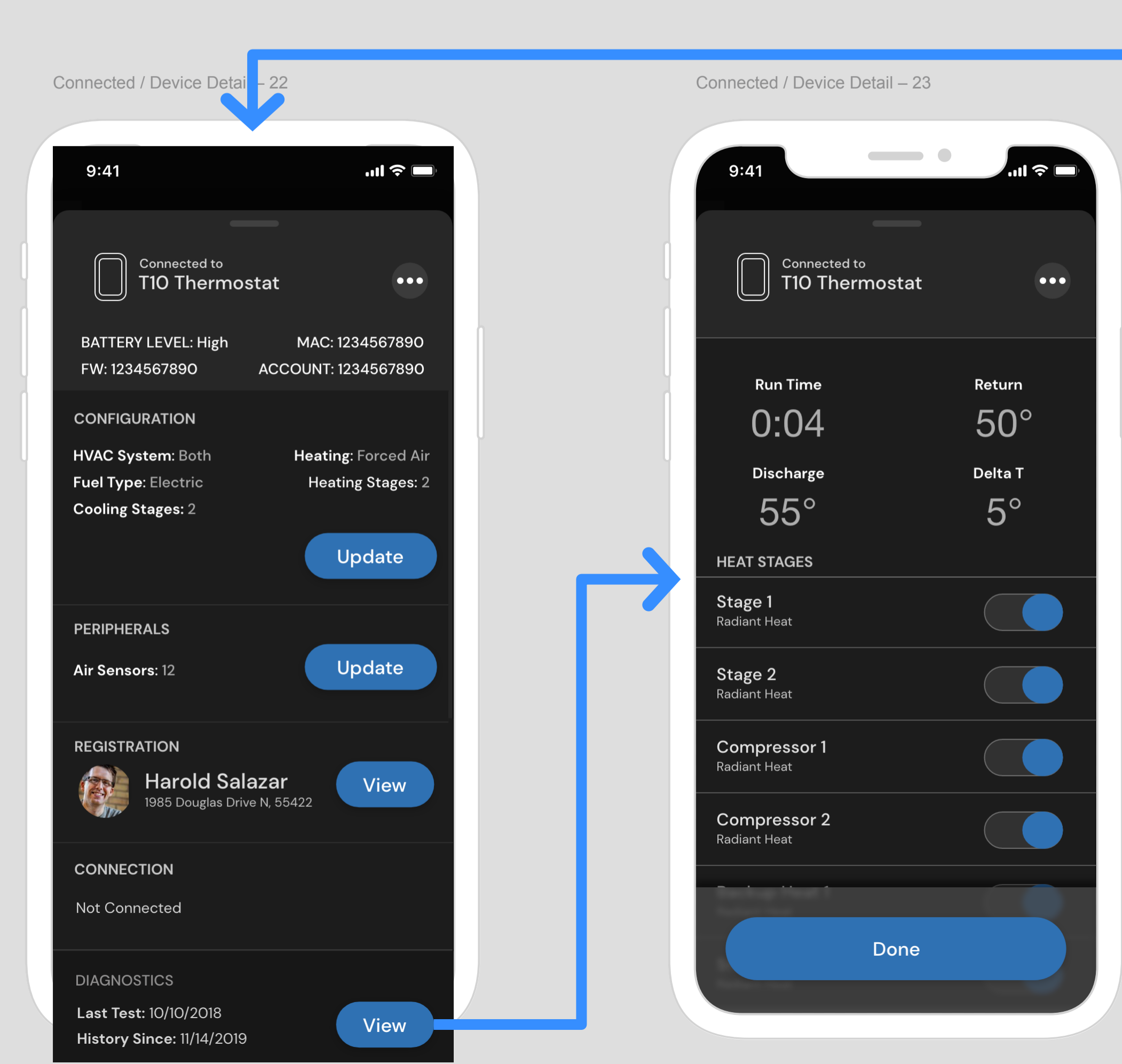

Dashboard

Disconnected / Tasks

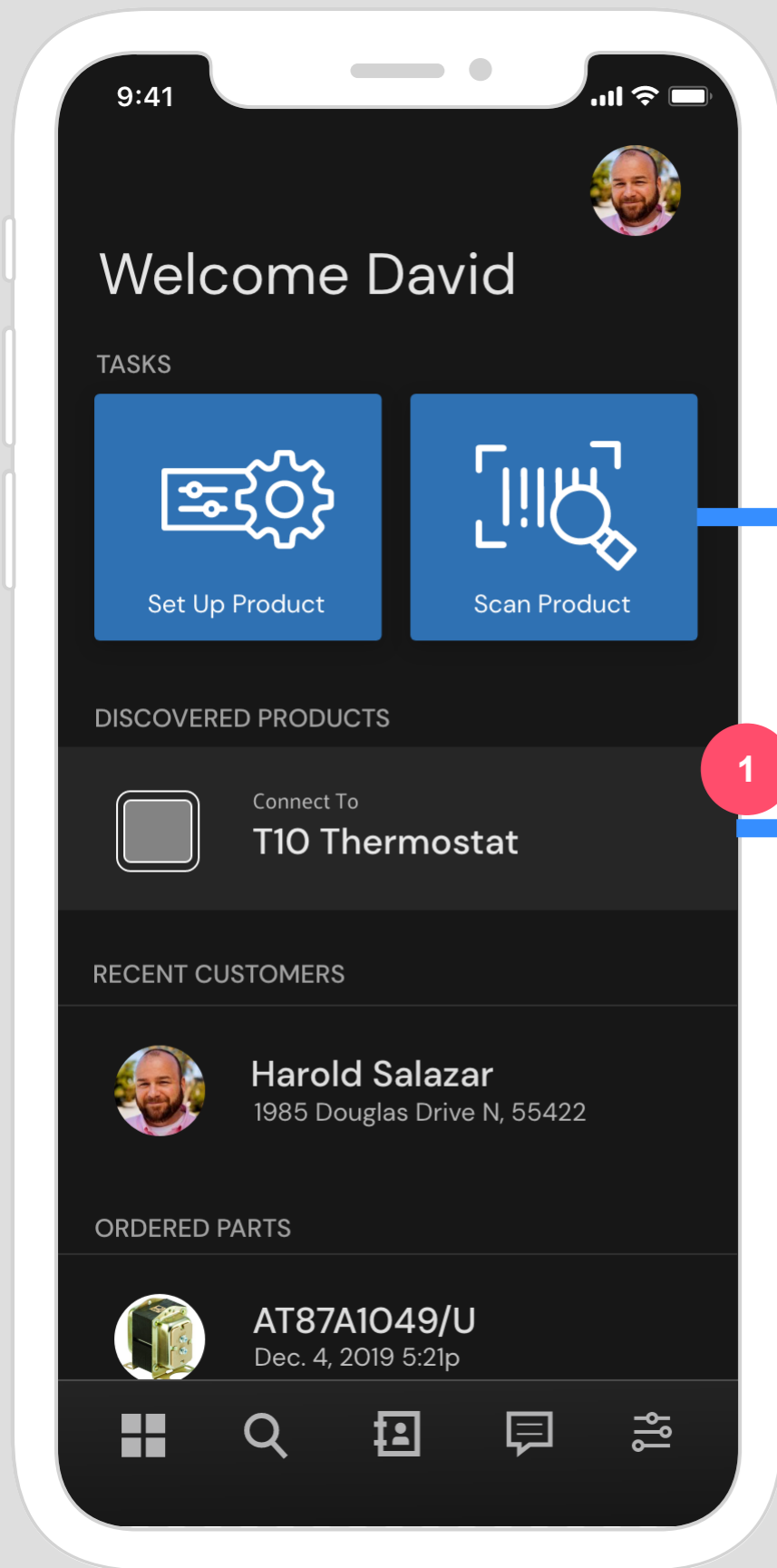

Connection

Disconnected / Install - 2

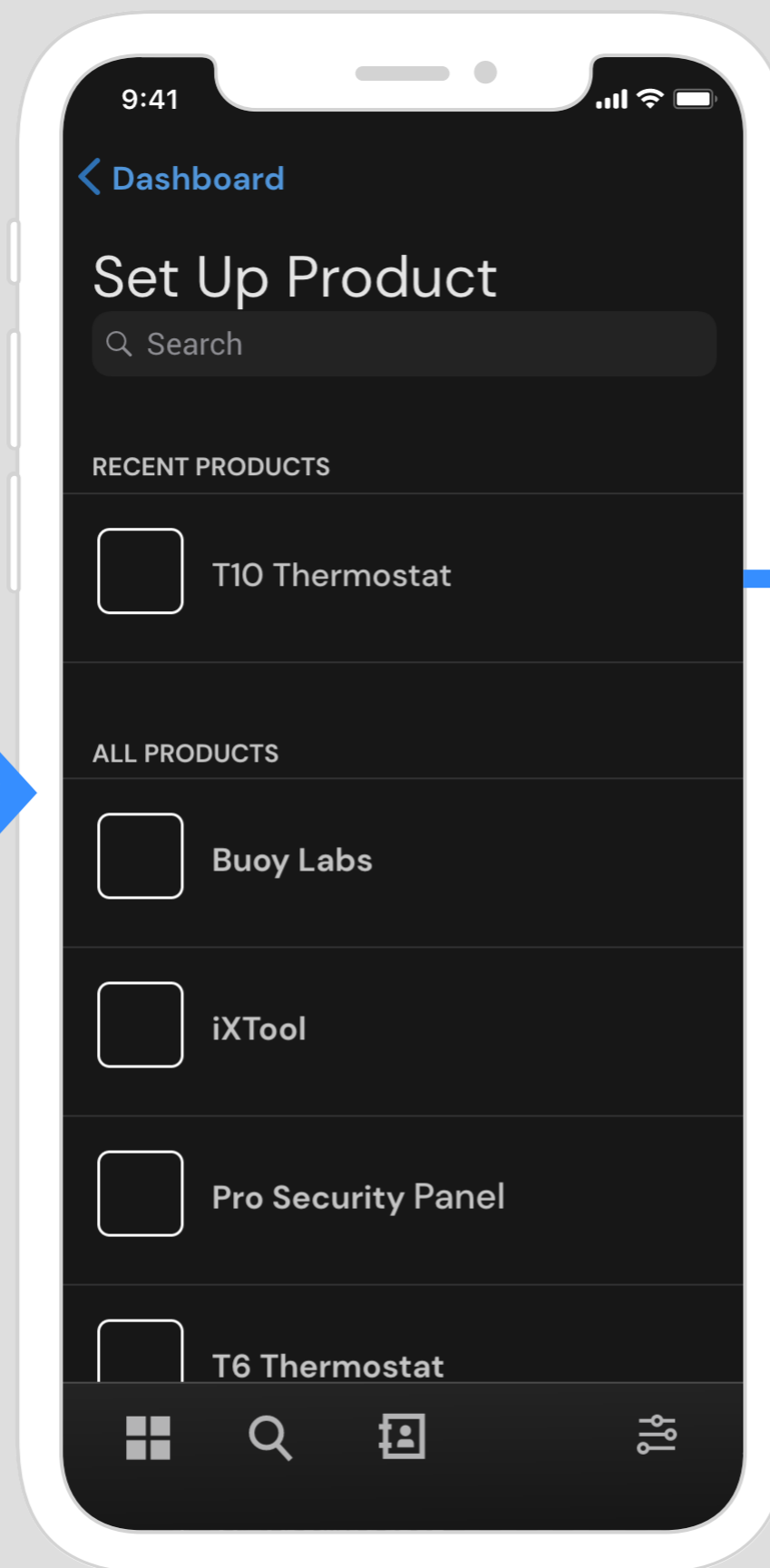

Disconnected / Install / Prepare - 4

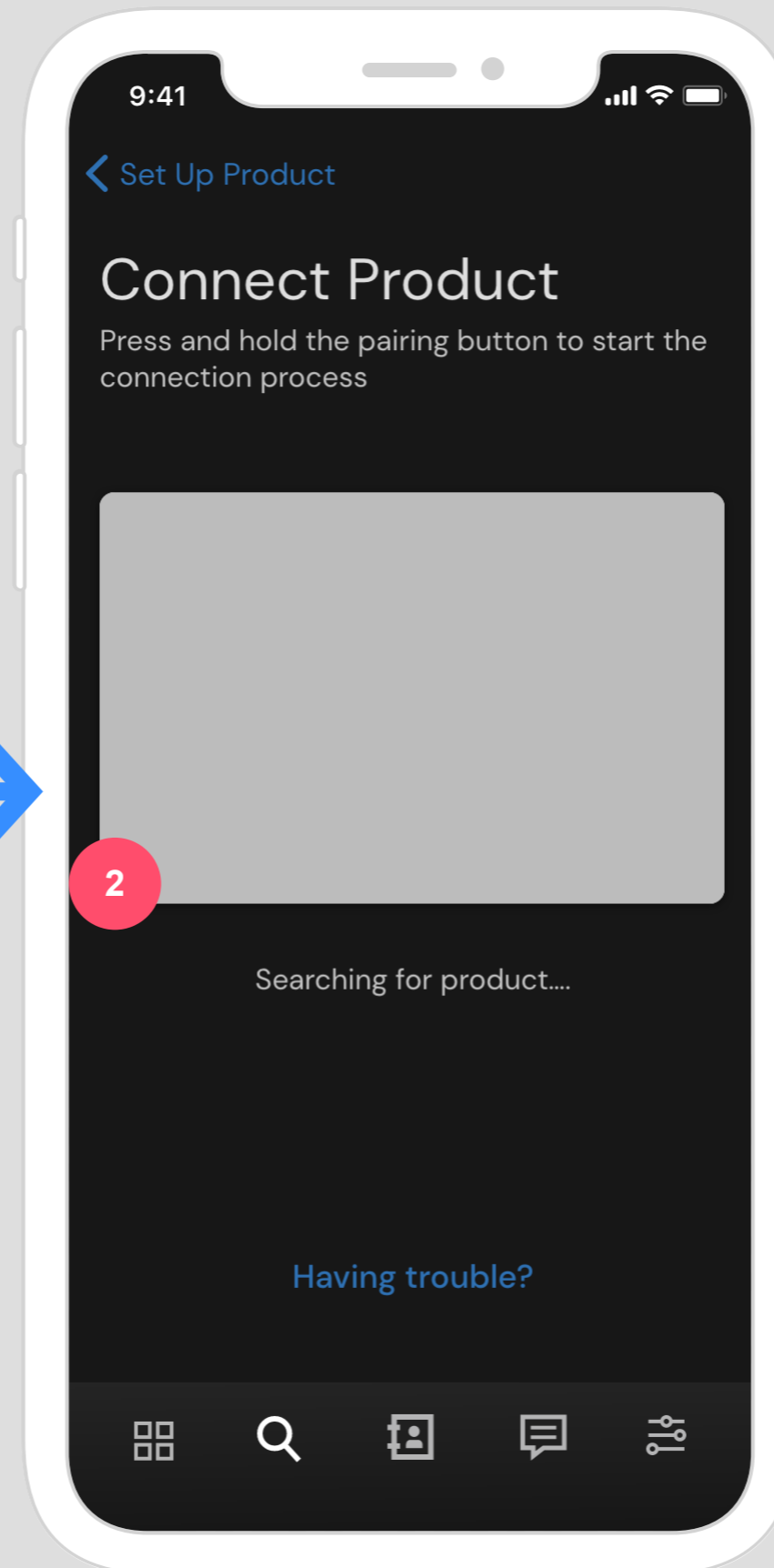

Disconnected / Install / Prepare - 5

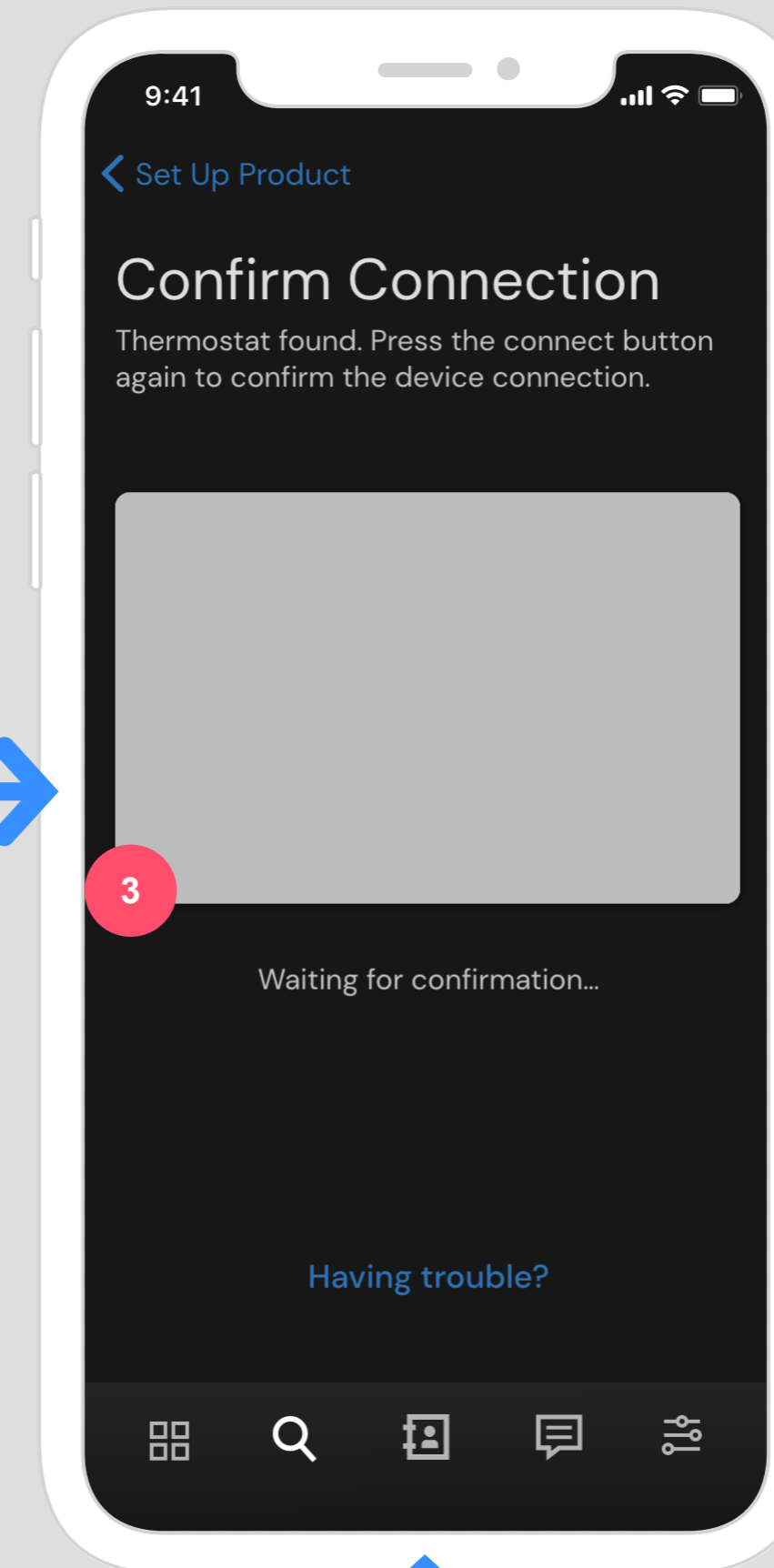

- 1 If device is put directly into BLE Broadcast, scan will pick it up within the dashboard
- 2 Alternate path allows Pro to receive instruction on how to initiate pairing. Whether in AP mode or in BLE Direct Connect, This screen will hold until a device is found.
- 3 Latest direction from firmware has a confirmation step on the device by pressing a button on the device

Configuration

Connected / Device Detail – 6

Connected / Device Detail – 16

Connected / Device Detail – 17

Connected / Device Detail – 1

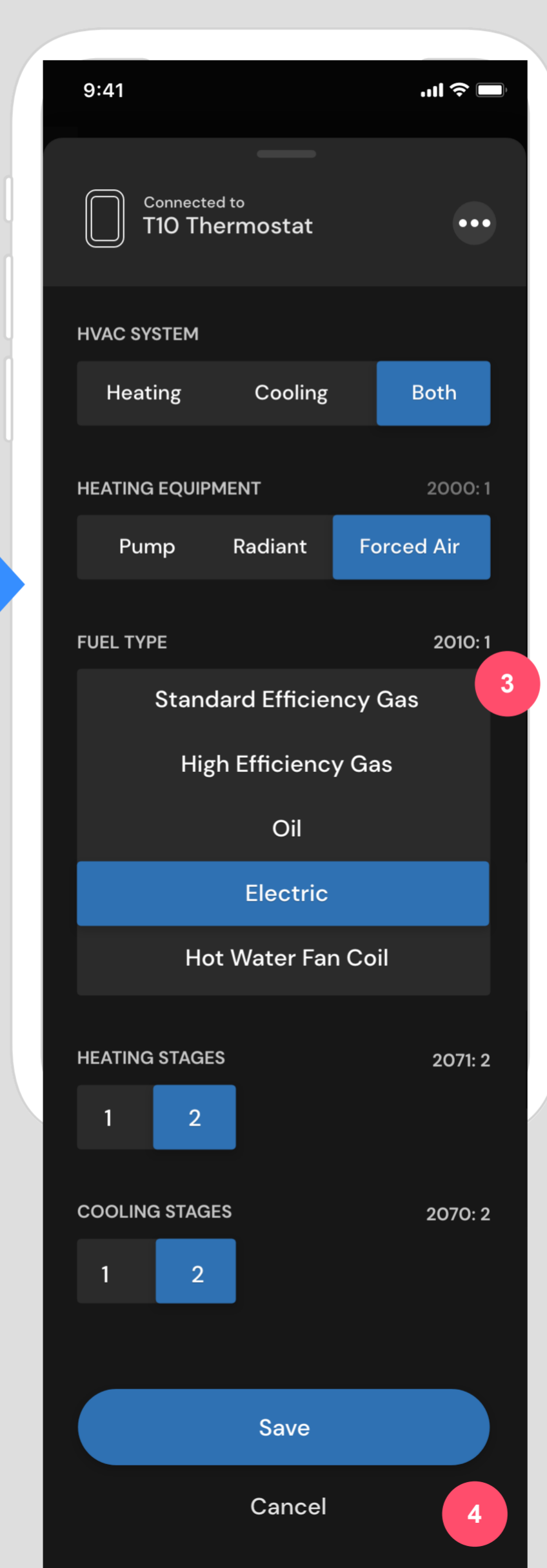
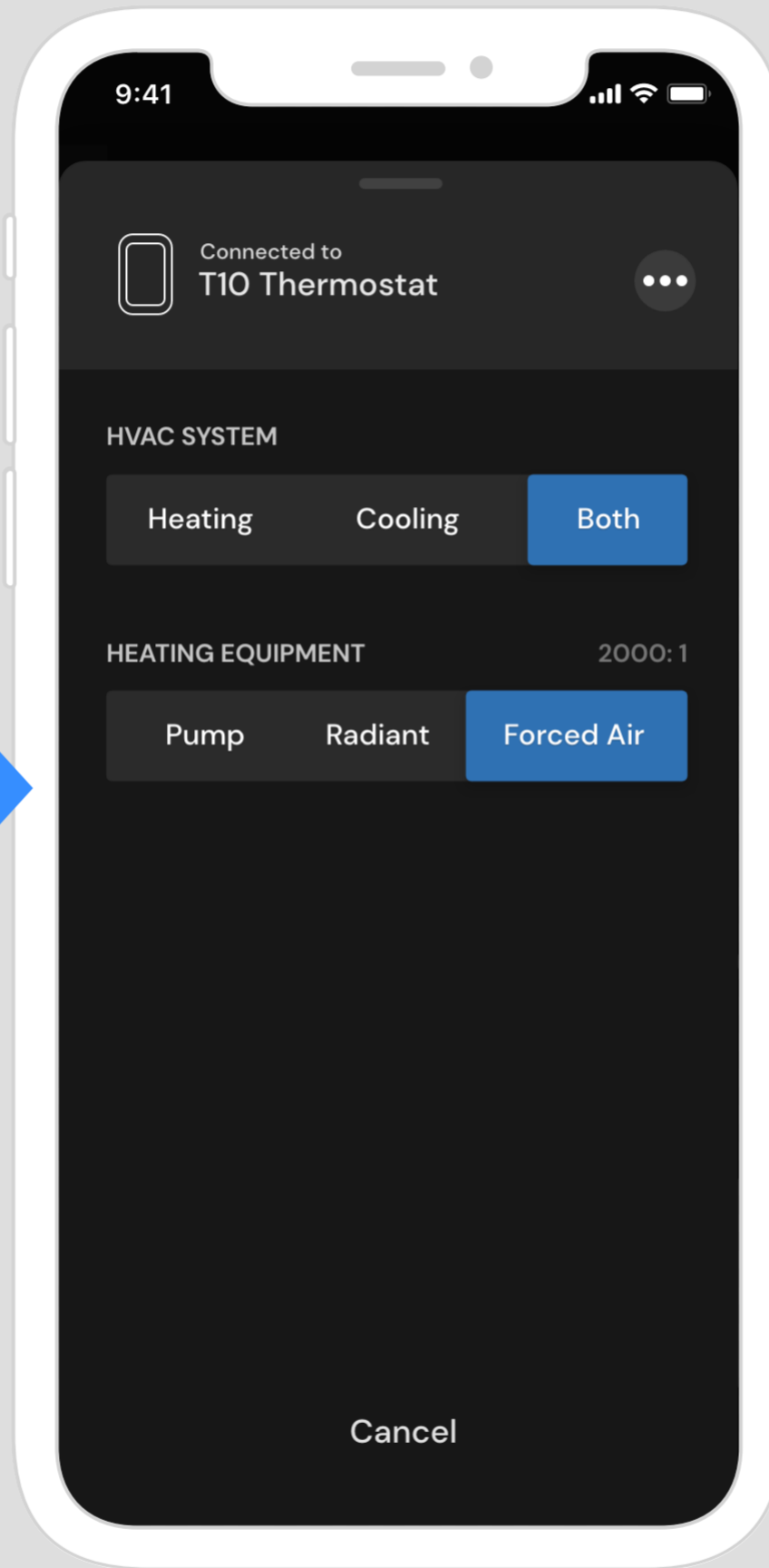
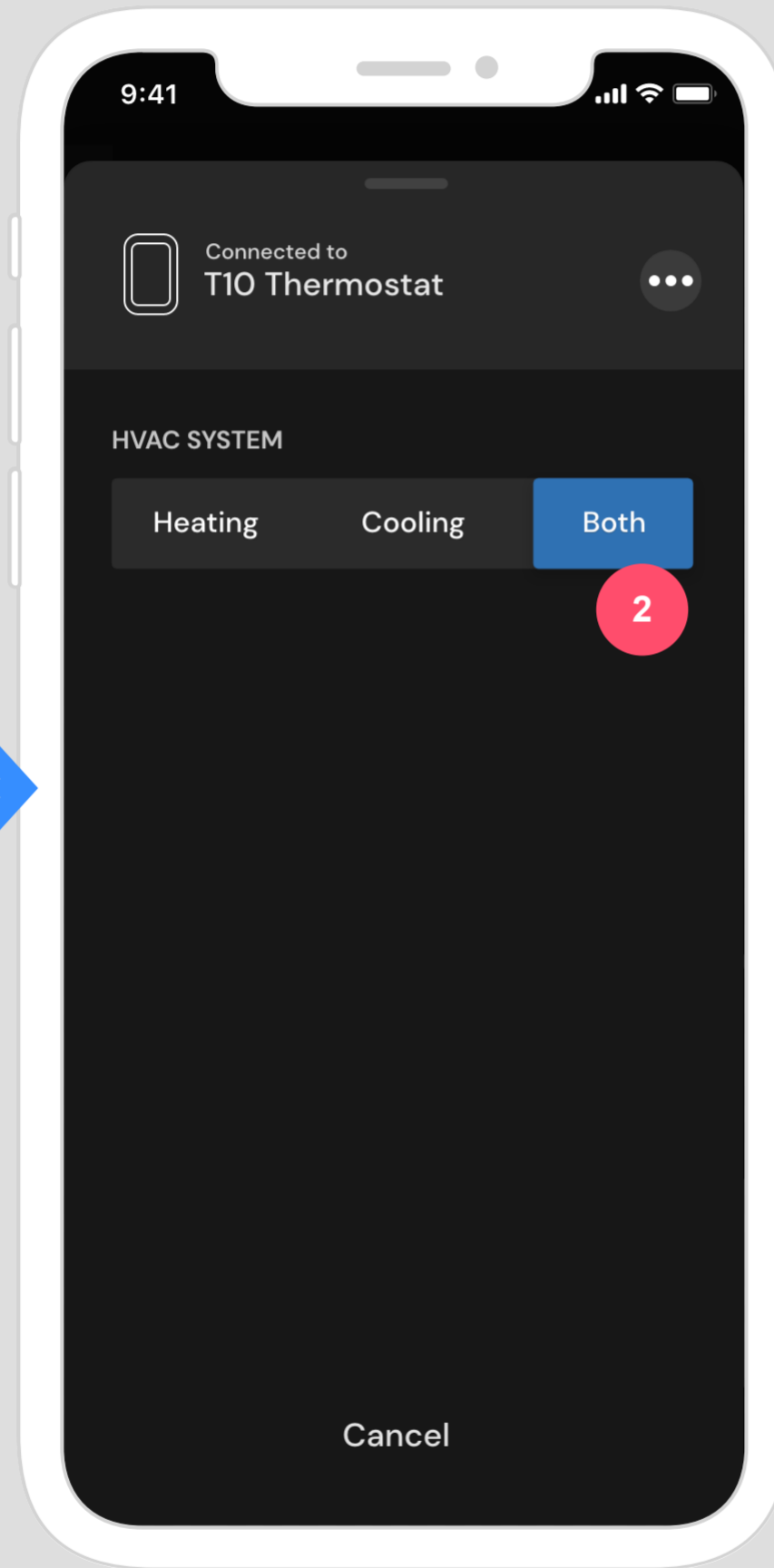
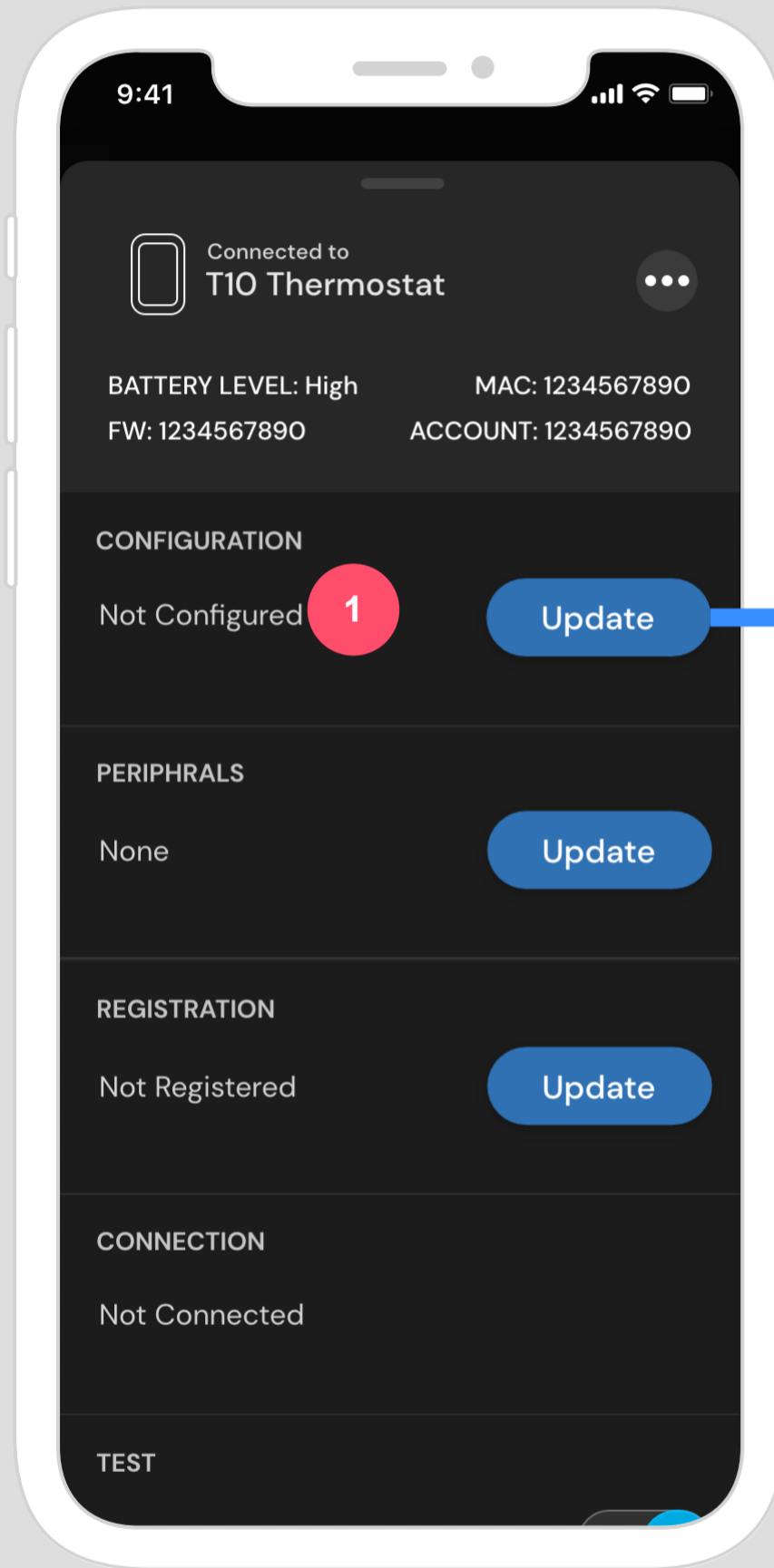

- 1 Configuration summary information appears here, to highlight most important details.
- 2 ISU values mapped to human readable text options. Values are populated sequentially as thermostat responds to previous round of ISU values.
- 3 When options extend beyond a reasonable width, options are stacked vertically
- 4 Save or cancel returns user to dashboard.

Range Control (Examples)

Connected / Configuration – 1

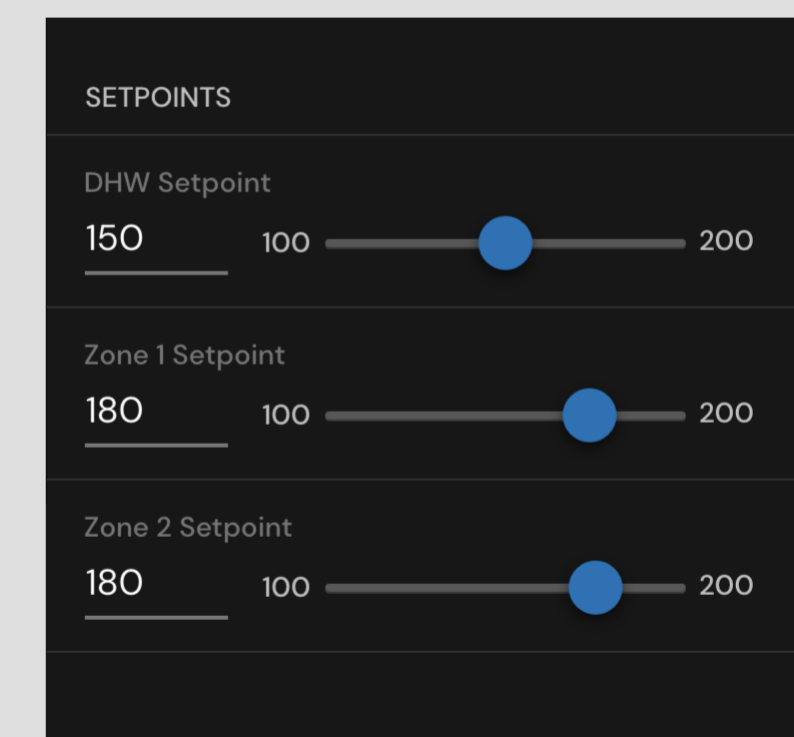

Peripherals

Connected / Device Detail – 18

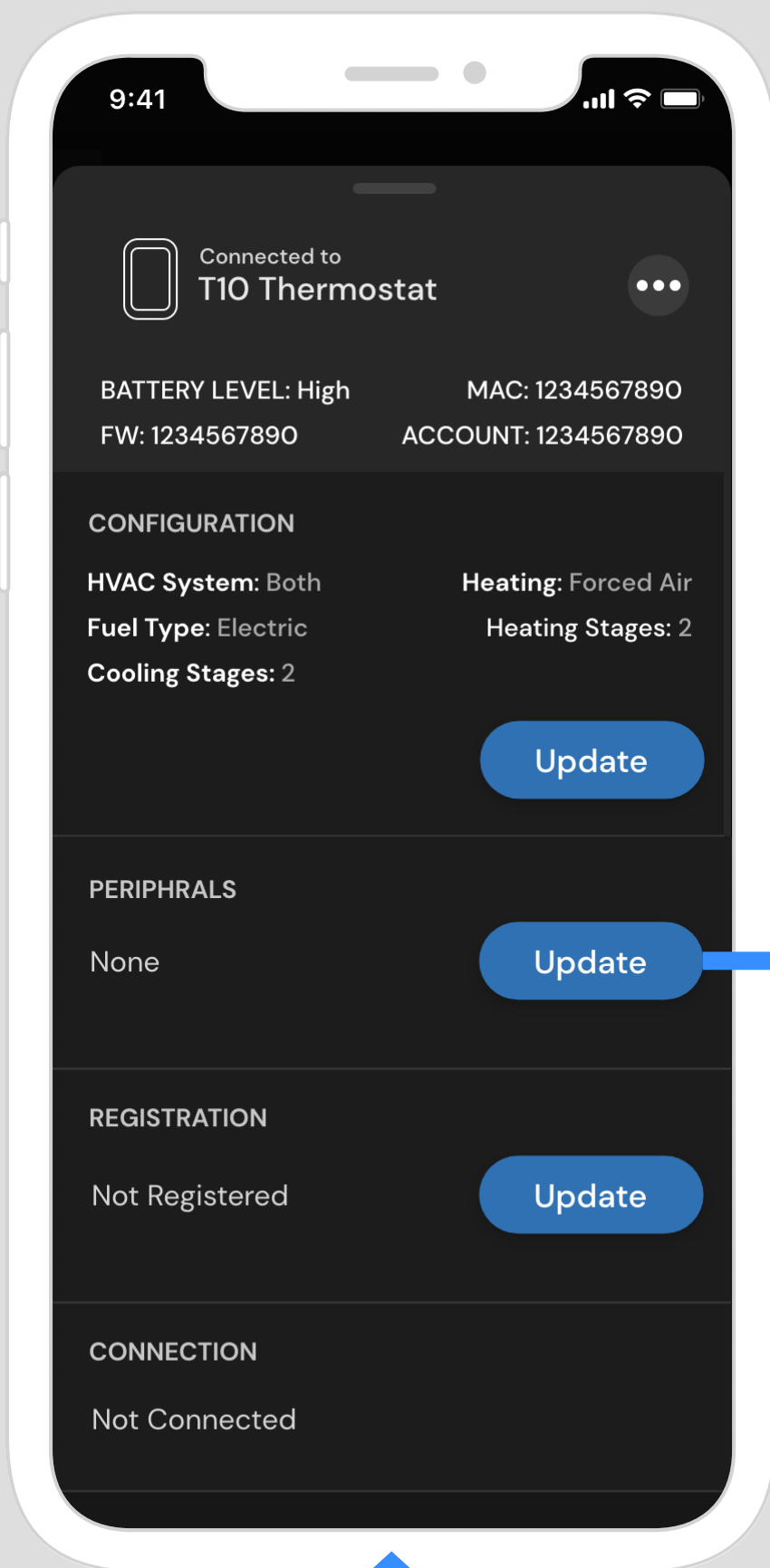

Connected / Device Detail – 15

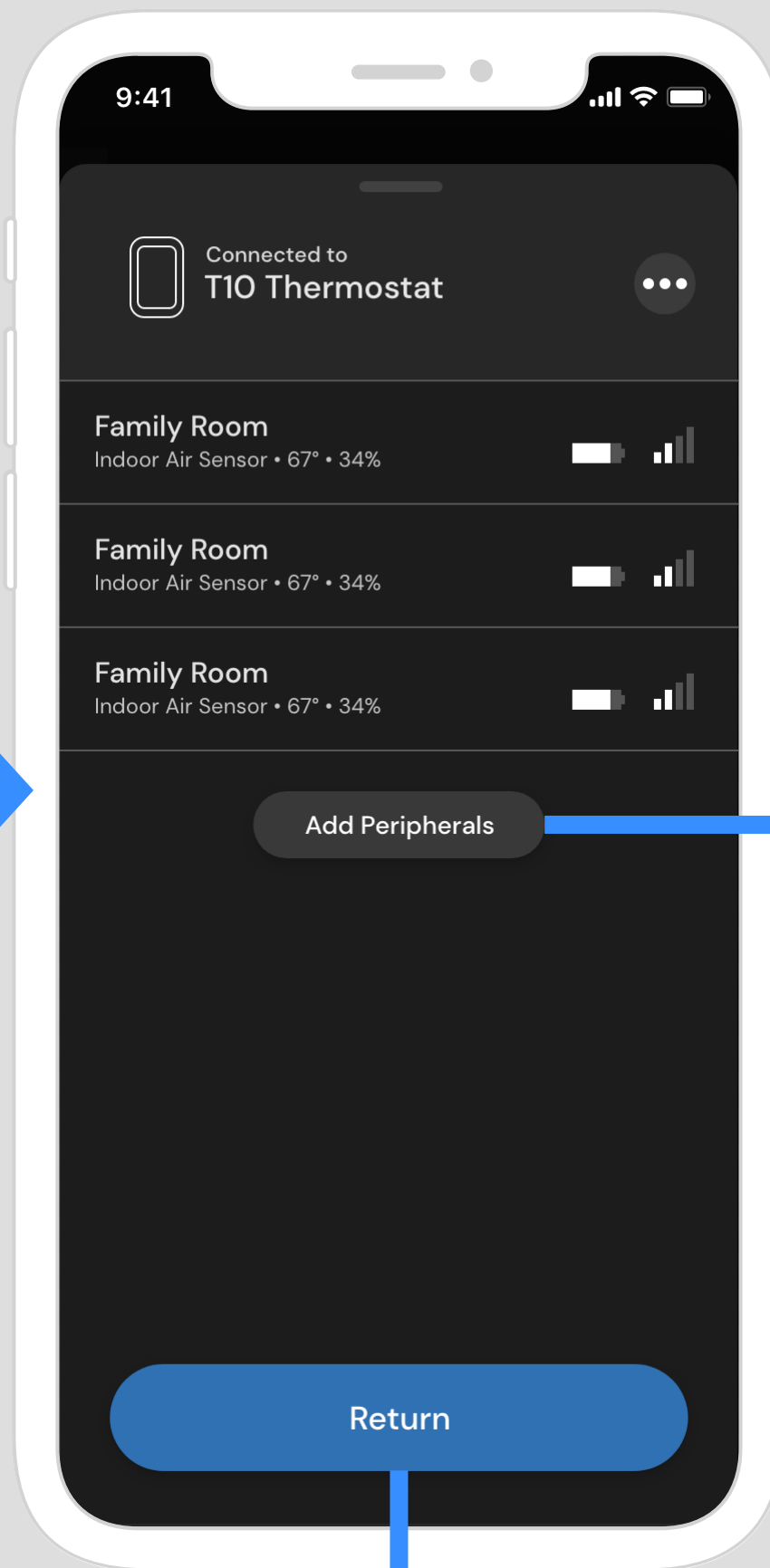

Connected / Device Detail – 21

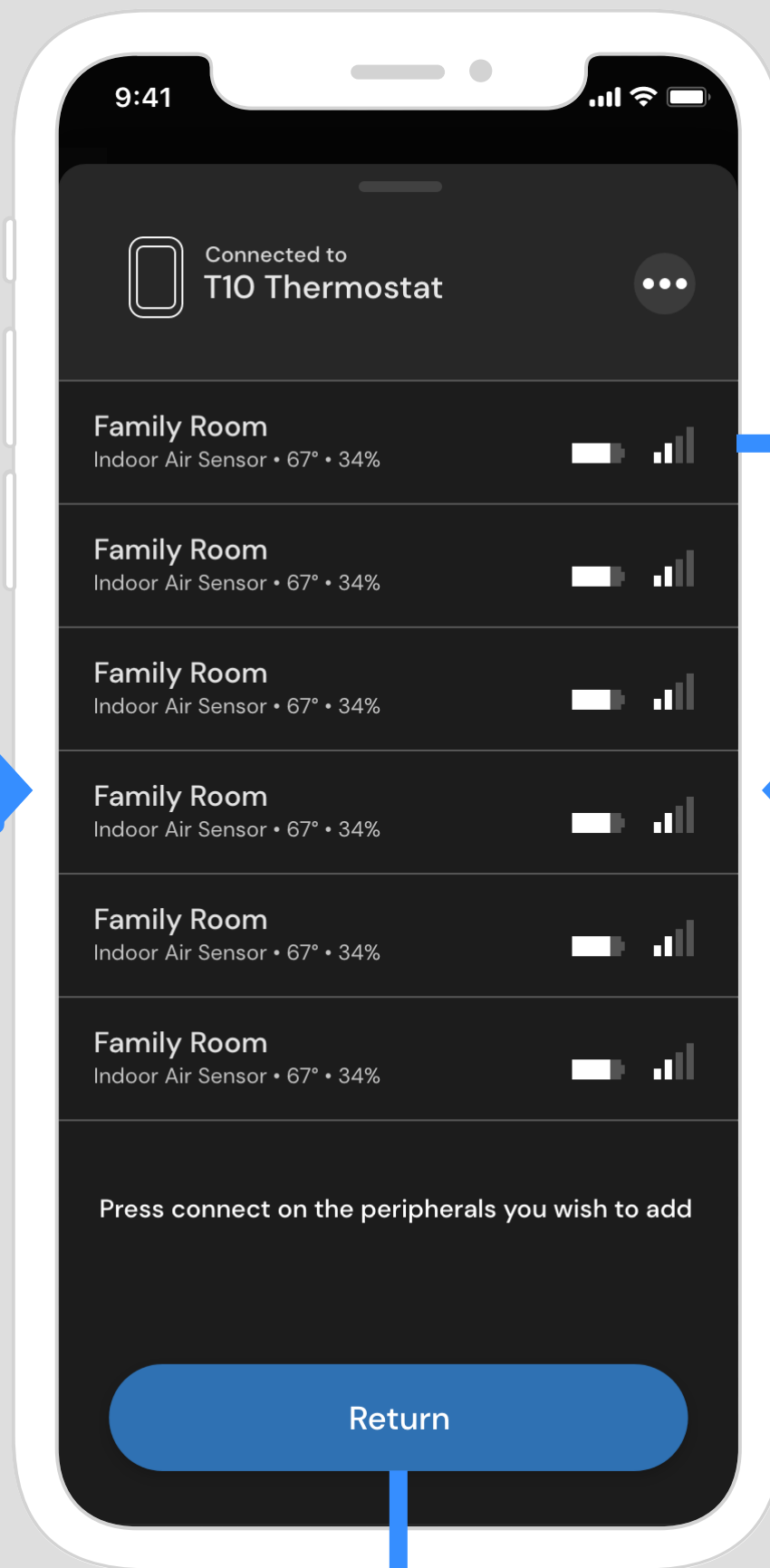

Connected / Device Detail – 20

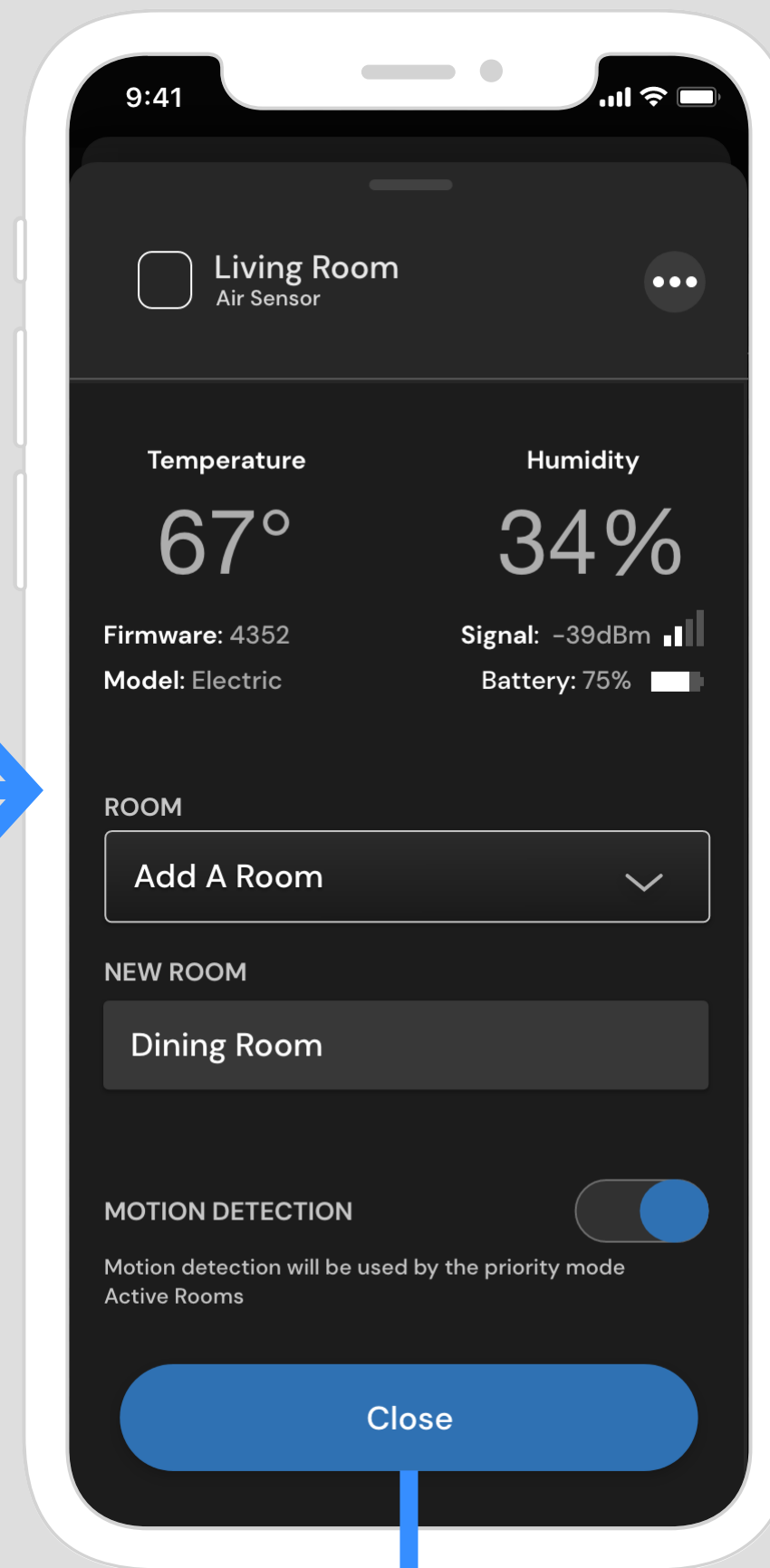

- 1 If device is put directly into BLE Broadcast, scan will pick it up within the dashboard
- 2 Alternate path allows Pro to receive instruction on how to initiate pairing. Whether in AP mode or in BLE Direct Connect, This screen will hold until a device is found.
- 3 Latest direction from firmware has a confirmation step on the device by pressing a button on the device

Registration

Connected / Device Detail – 19

Connected / Device Detail – 7

Connected / Device Detail – 8

Connected / Device Detail – 22

Disconnected / Customers – 1

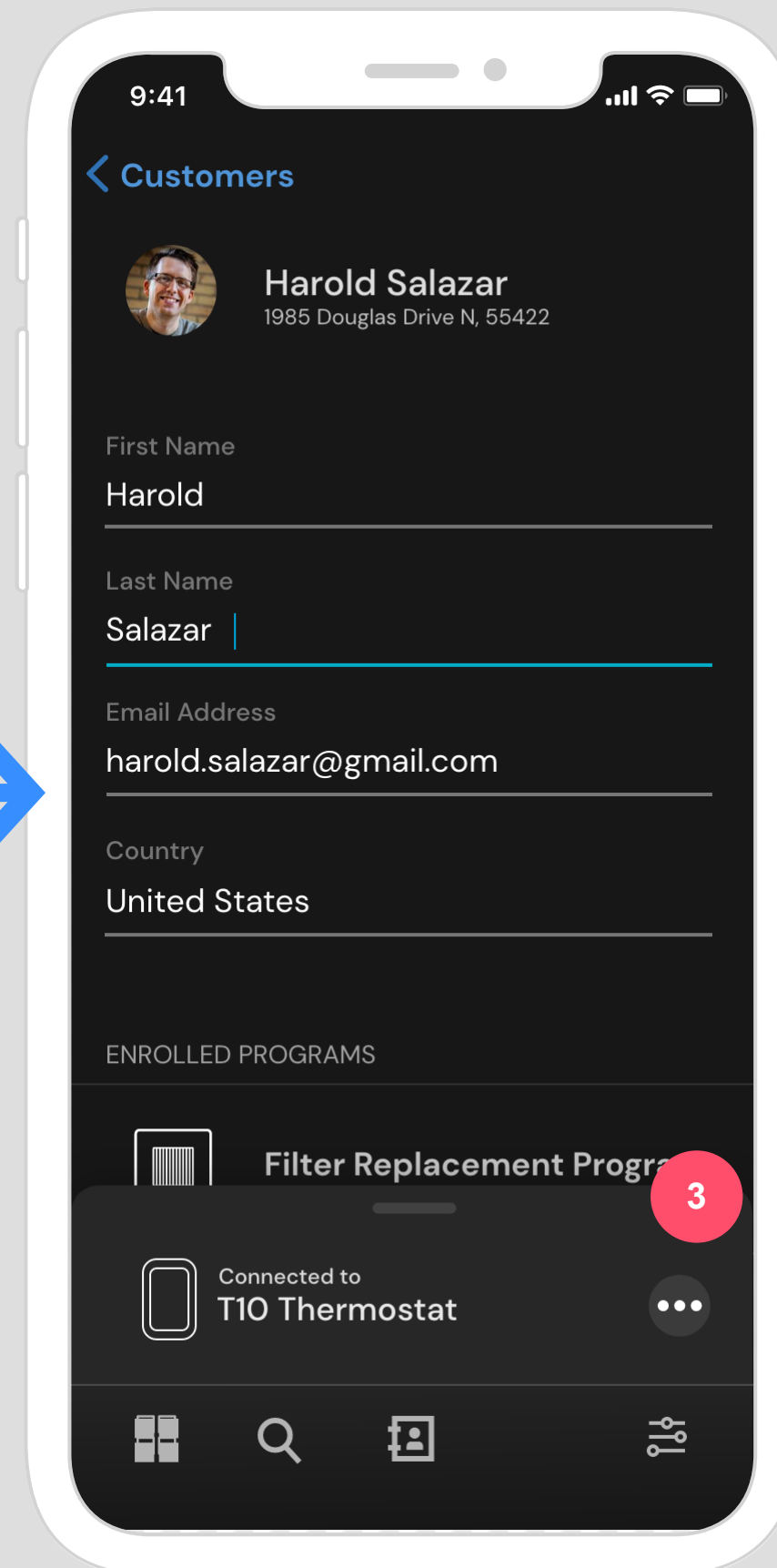
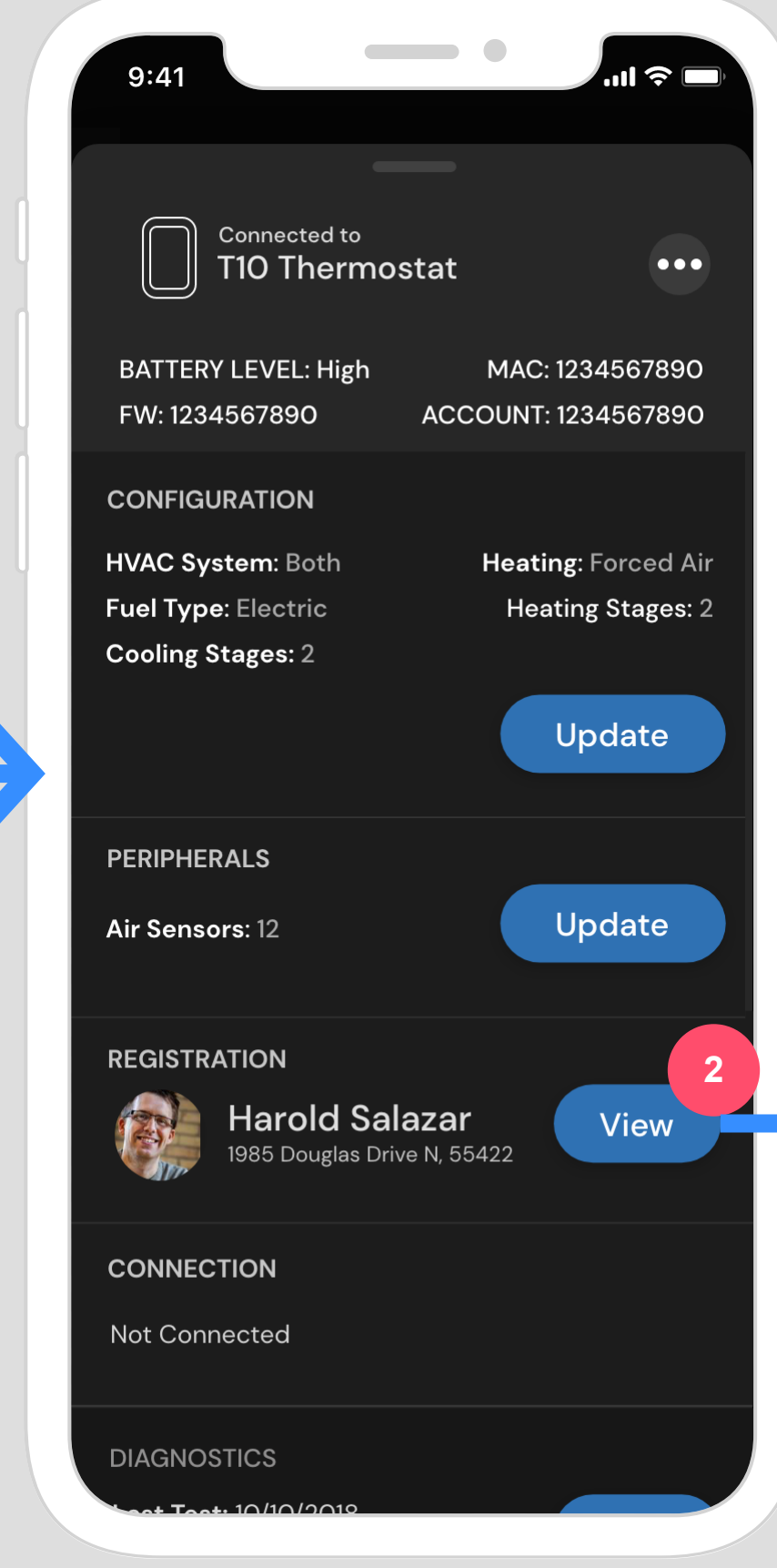
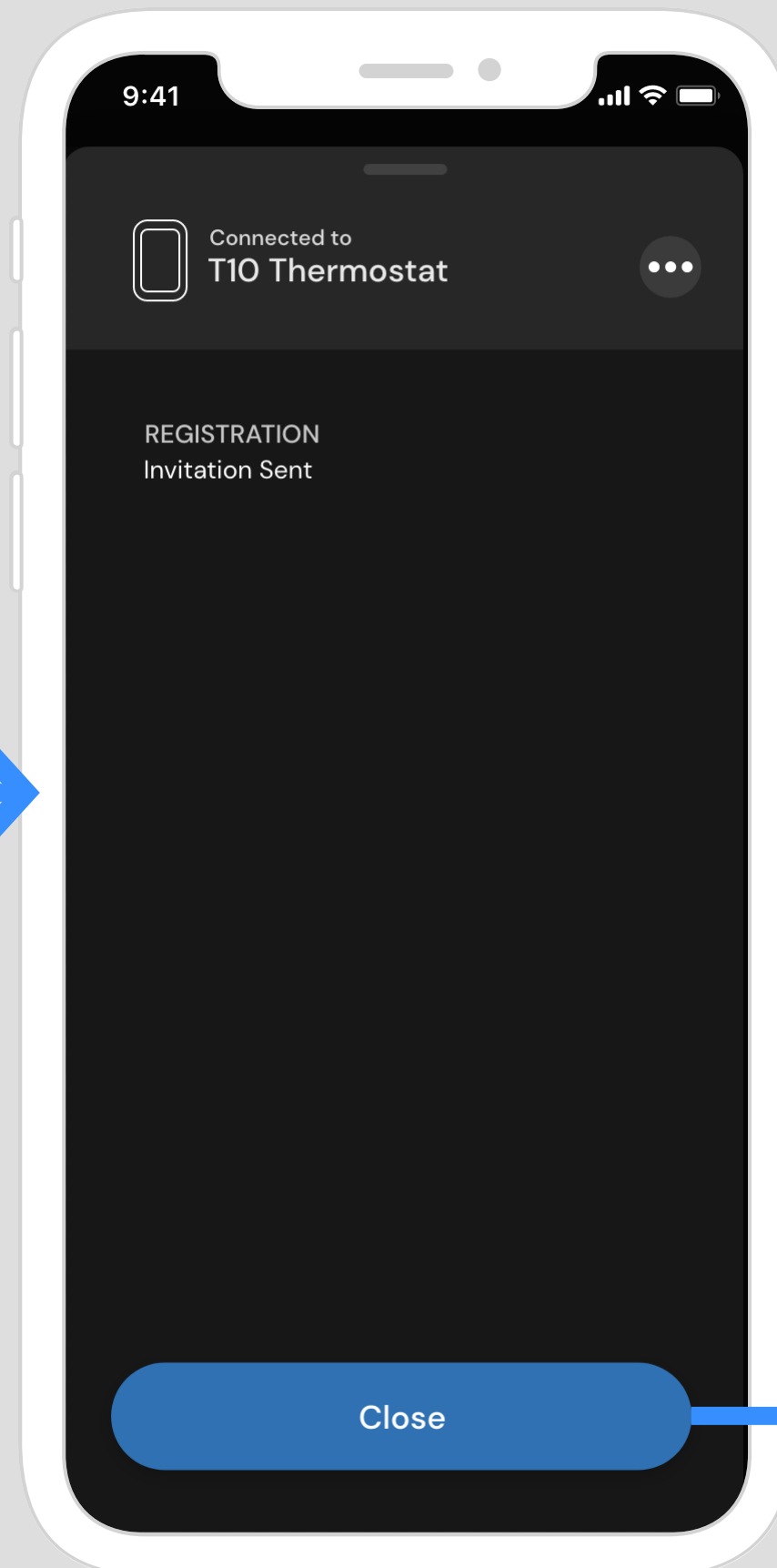
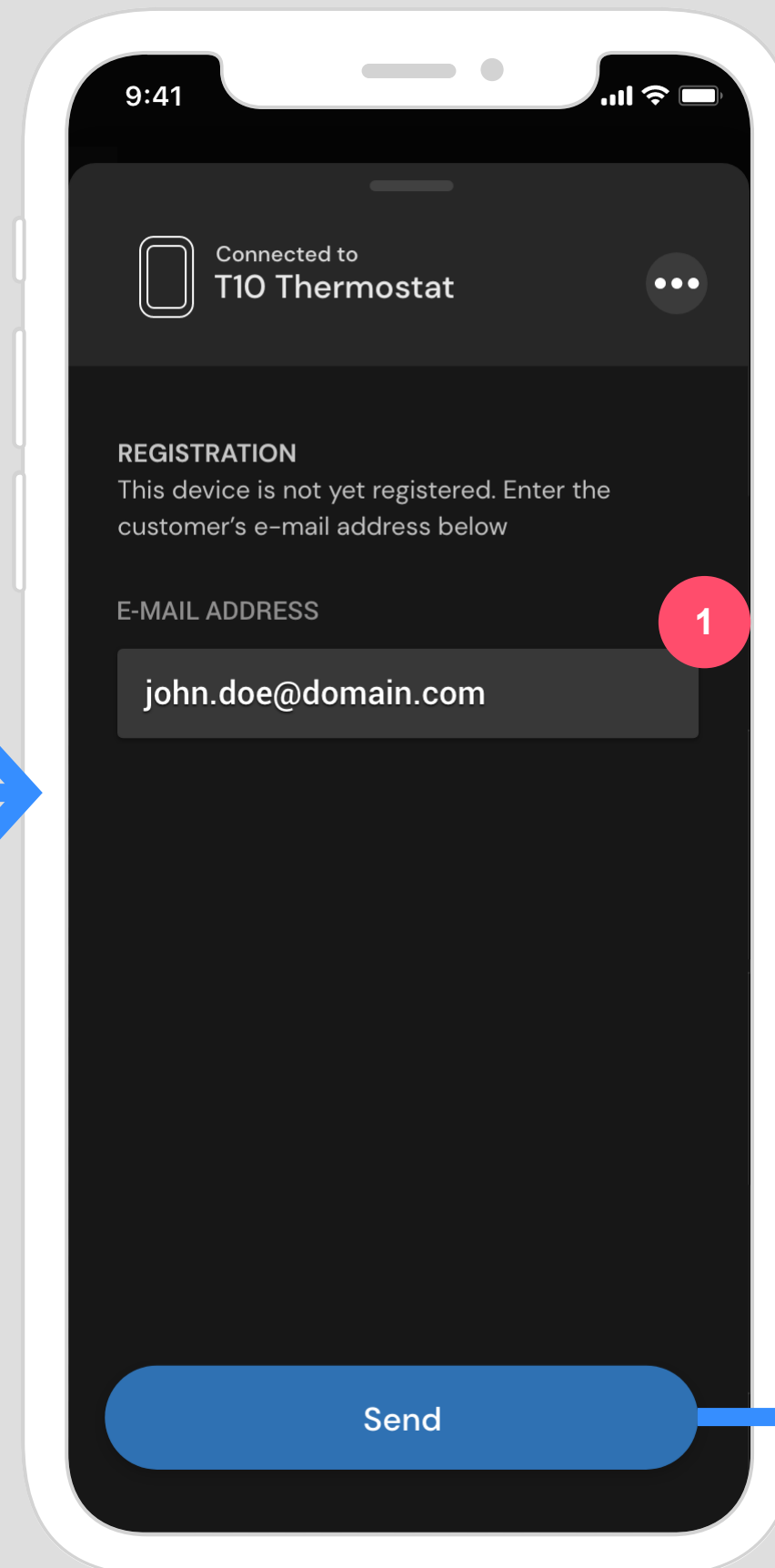
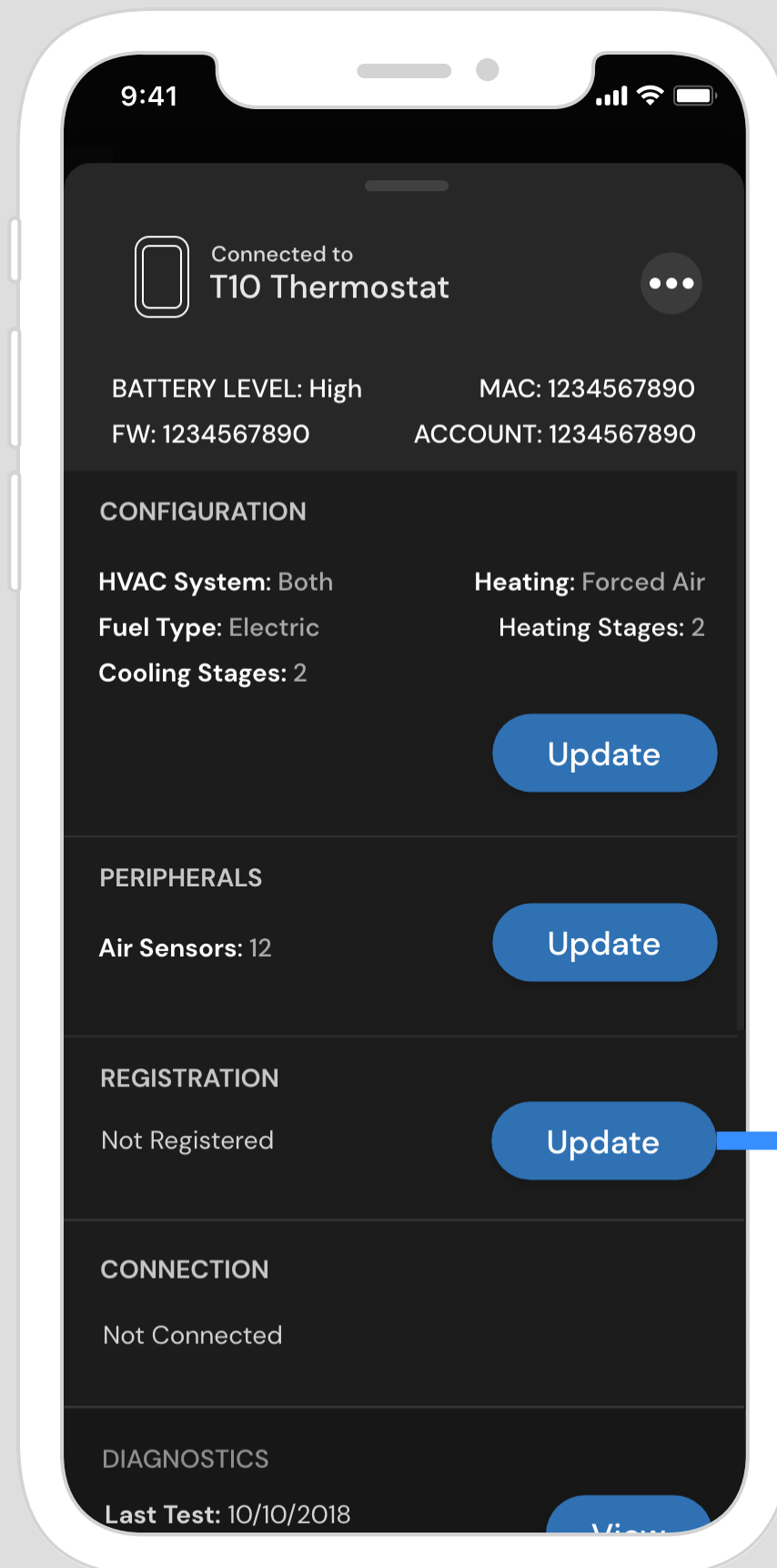

- 1 E-mail invitation used in "seamless handoff"
- 2 Selecting View will collapse the device card and direct link to customer detail view.
- 3 RMR options and customer information can be updated. To return to the device, the pro can swipe back up at any point on the bottom sheet.

Diagnostics

Connected / Device Detail – 22

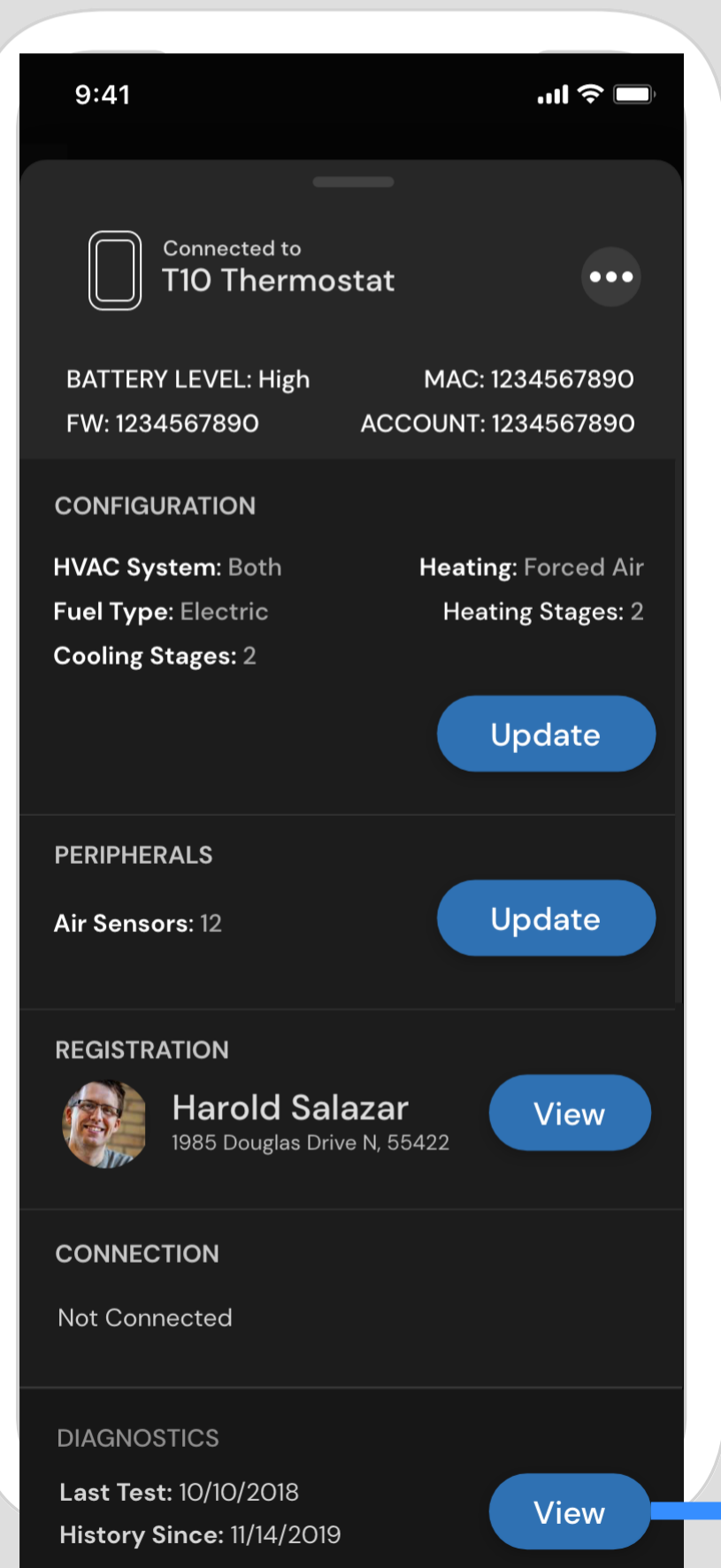

Connected / Device Detail – 23

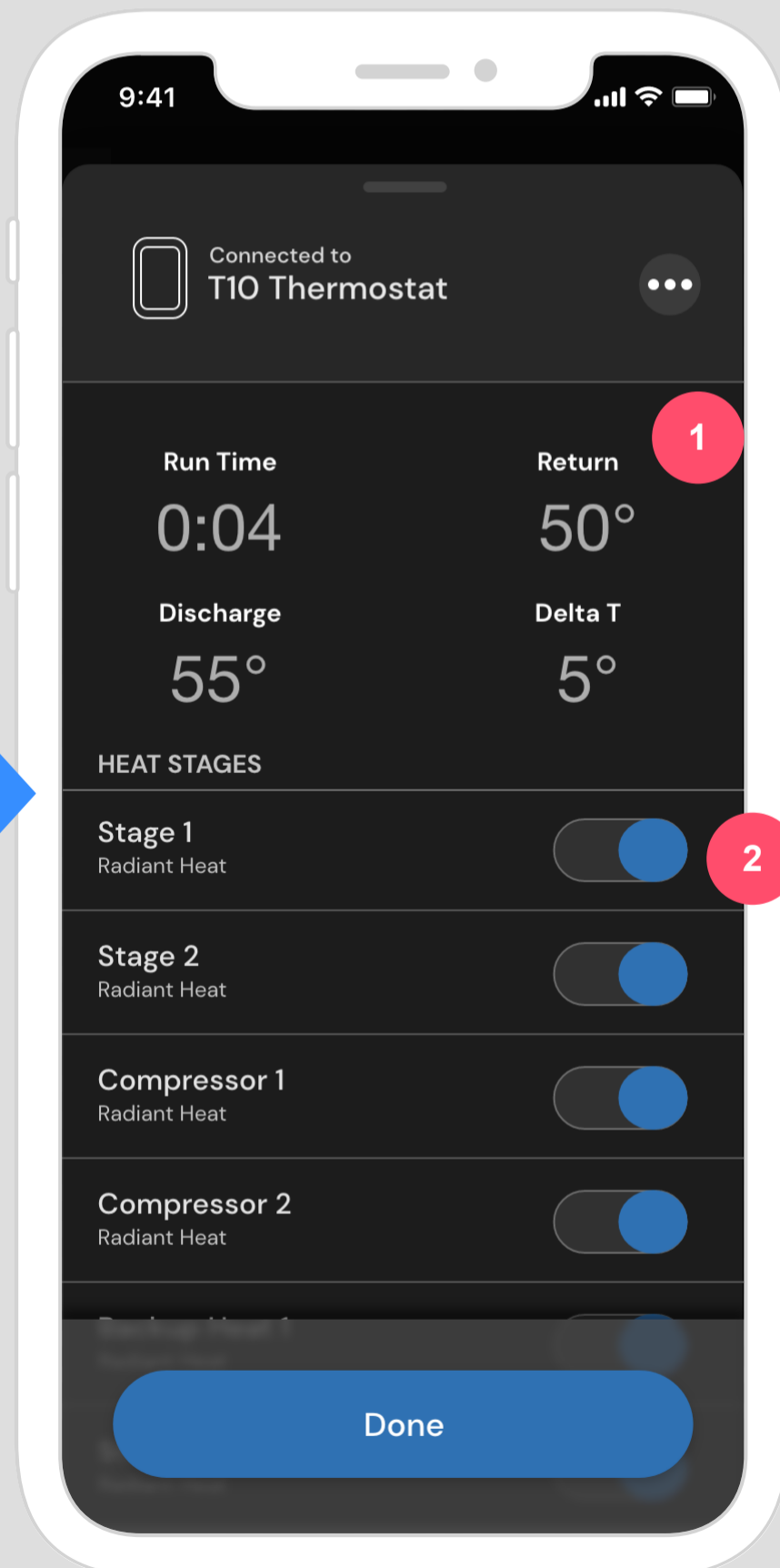

- 1 Header displays real-time data from device.
- 2 Manual toggles available for thermostats to allow quick toggles of certain controls within the system. **Options available determined by configuration***